



**HSD 40li**  
MANUAL

• GB •

## Welcome

Congratulations on purchasing this HSG 401i. You can now listen to FM radio and play music from your iPhone, iPod or iPad.

Please read the warning section on page 13 carefully before using your HSG 401i.

## You should have

HSG 401i

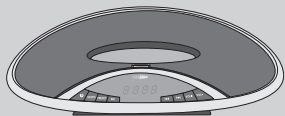

Remote Control



AC/DC Power Adapter

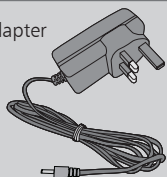

## You may also need

- 3.5 mm Line In cable

## Contents

Your HSG 401i

01

Setup

02

Everyday use

03

Advanced use

04

Troubleshooting

05

Maintenance

06

Warnings

07

Technical specifications

08

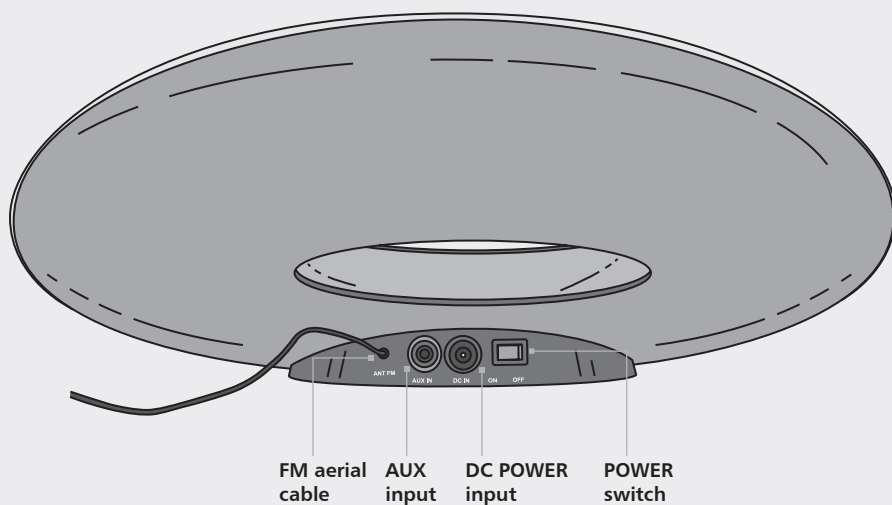
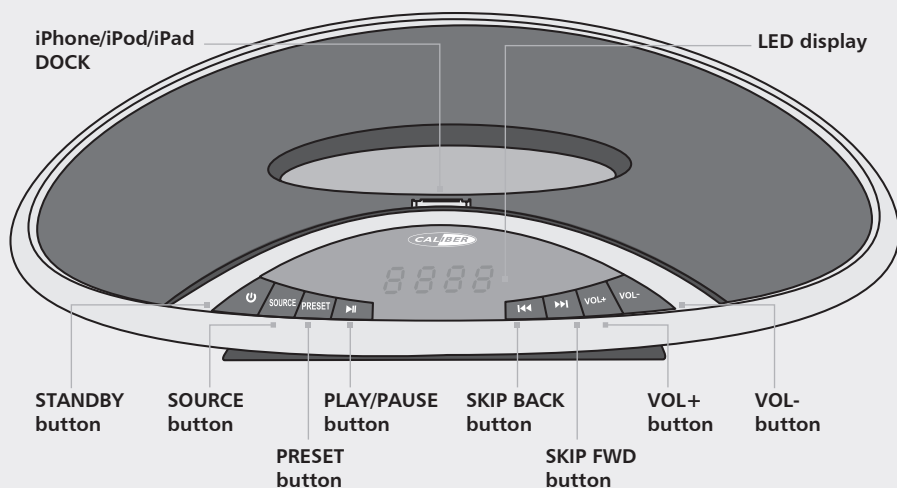

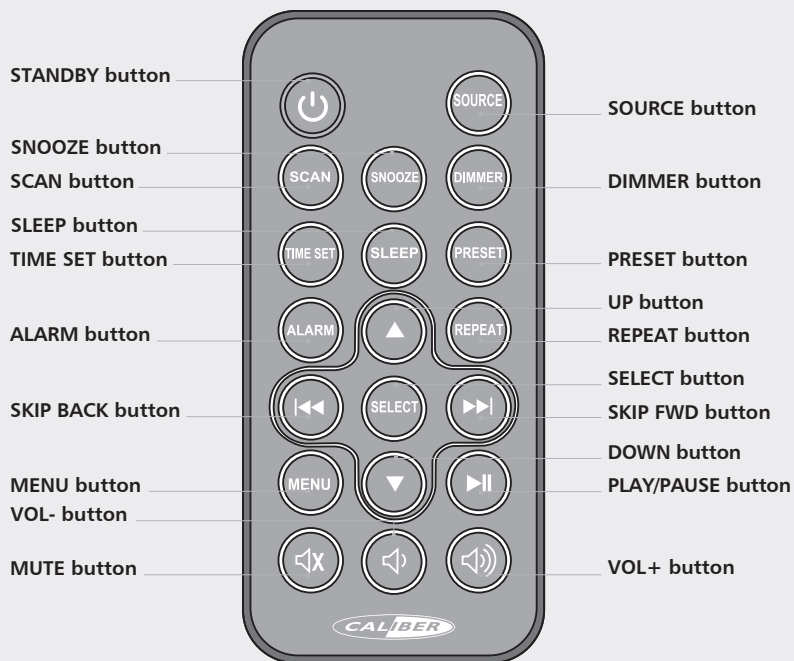

### Setting up your Dock

- 1 Plug one end of the included **AC/DC cable** into the **DC POWER input** on the back of your Curve iPad Dock. Plug the other end into a standard power socket.
- 2 Switch the power to **ON** on the rear of the unit.
- 3 Extend the **FM aerial cable** on the back of the unit.

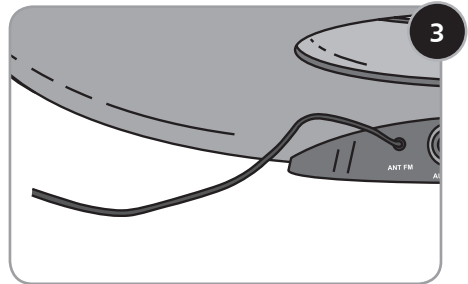
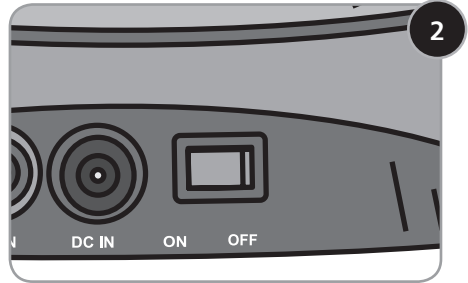
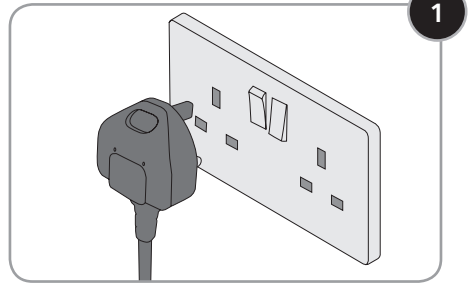

#### Note:

##### Aerial positioning

You may need to reposition the aerial for optimal reception. The best position is dependent on the station and the strength of the signal.

#### Note:

If not using the unit for a long time, disconnect the AC/DC adaptor from the wall outlet.

### The remote control battery

The remote control comes fitted with a 3V battery. The battery is already inserted into the remote control and blocked by a plastic sheet.

#### Note:

Remove the plastic sheet before operating the remote control.

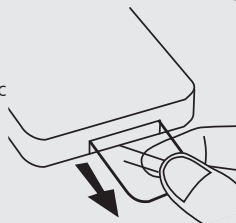

### Battery replacement

When the battery becomes weak, the operating distance of the remote control is greatly reduced and you will need to replace it as described below.

- 1 Slide the battery draw out from the bottom of the remote. You will need to release the clip at the side of the draw. The draw will slide out as shown.
- 2 Remove the old battery, then insert a new one with the same or equivalent type, make sure the positive (+) side is facing upwards as shown.
- 3 Slide the draw closed, it will click into place.

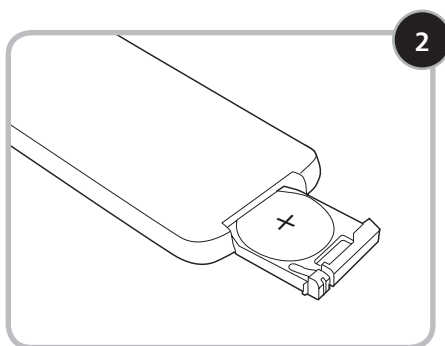
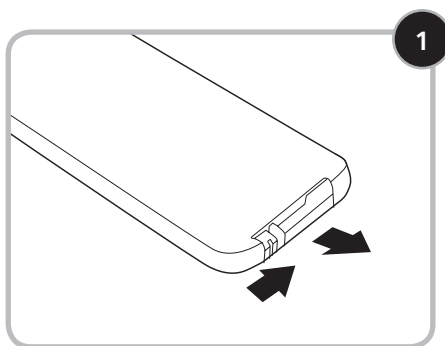

### Setting the time

After plugging your Curve iPad Dock into a mains power socket, your Curve iPad Dock will be in **STANDBY mode**.

- 1 Press and hold the **TIME SET button** on the remote control to set the time
- 2 Press the ▲ and ▼ buttons to set the hour. Confirm by pressing the **TIME SET button**.
- 3 The minute will flash, use the ▲ and ▼ buttons to set the minute and confirm by pressing the **TIME SET button**.

### Using the FM radio

Turn on your Curve iPad Dock by pressing the **STANDBY button**. An FM frequency will be displayed on the **LED display**.

- 1 You can select the desired frequency manually by pressing and holding the ◀◀ or ▶▶ button or by pressing the **SCAN button**.
- 2 Fine tuning can be performed by pressing the ◀◀ or ▶▶ button once, and repeating until the desired frequency is found.

#### Tip:

Where a button that appears on both the unit and the remote control is referenced in this guide you can use either button to perform that function.

## Playing your iPhone, iPod or iPad

You can play your iPhone, iPod or iPad through your unit. Connect your iPod to the dock on the front of your unit. For a list of compatible iPhone/iPod/iPad types, see below.

iPod touch (2nd, 3rd and 4th generation)
iPod nano (3rd, 4th, 5th and 6th generation)
iPhone 4S, iPhone 4, iPhone 3GS, iPhone 3G
iPad (2nd and 3rd generation)

Press the **STANDBY** button to turn on the unit. Press the **SOURCE** button repeatedly until “iPod” appears on the display.

When your iPod is connected you can control playback as you would normally on the device.

The first time you dock your iPod/iPhone/iPad the unit will automatically sync to the time of the docked iPod/iPhone/iPad.

Press the **▶||** button to play your chosen track, you can press it again to pause playback. Press and hold the **▶||** button to stop playback on your iPod/iPhone/iPad.

Press the **◀◀** or **▶▶** button to skip the current track backwards or forwards. Press and hold the **◀◀** or **▶▶** button to rewind and fast forward songs. Press the **REPEAT** button on the remote control to choose between different **REPEAT modes**.

## Playing External devices

You can connect an external audio source like an MP3 player using a **3.5mm audio cable** (not supplied).

- 1 Connect one end of the cable to the device's headphone output and the other end to the **AUX IN input** on the back of the unit.
- 2 Press the **SOURCE** button repeatedly to select the **AUX mode**. The **LED display** will show 'AUH'.
- 3 Use the controls on your device to play your audio as you would normally.

## Brightness of backlight preset

In **POWER ON mode**, the default setting of the backlight is bright.

In **STANDBY mode**, the default setting of the backlight is dim.

Press **DIMMER** button on remote control to adjust the brightness of backlight of the **LED display** in either **STANDBY** or **POWER ON mode**.

### Note:

#### Volume

You can select the desired volume using the **VOL+** and **VOL-** buttons.

### Saving your favourite station

To save your favourite stations:

- 1 Tune to the station you would like to save as preset in **FM mode** just as you would for normal listening.
- 2 Press and hold the **PRESET button** to store the desired station.
- 3 Press the **◀▶** or **▶▶** button to select the desired station from **ch** (channel) 0-9. Press the **PRESET button** or **SELECT button** to confirm your choice.

You can save up to 10 stations.

### Listening to your favourite stations

In **FM mode**:

- 1 Press the **PRESET button**.
- 2 Press the **◀▶** or **▶▶** button to select your desired preset station number then press the **PRESET button** or **SELECT button** to confirm your choice.

### Setting the alarm

In **STANDBY mode**:

- 1 Press and hold the **ALARM button** on remote control to set the alarm. The hour will flash on the **LED display**.
- 2 Press the **▲** and **▼** buttons to set the hour. Confirm by pressing the **ALARM button**.

- 3 The minute will now flash on the **LED display**. Press the **▲** and **▼** buttons to set the minute. Confirm by pressing the **ALARM button**.
- 4 To select the source of your alarm use the **▲** and **▼** buttons. You can choose between **bu** (buzzer) **F** (FM radio) or **iPod**.
- 5 The Volume will now be displayed on the screen, press the **▲** and **▼** buttons to select the desired volume.
- 6 Confirm your choice by pressing the **ALARM button**.

You can check if your alarm is active, a dot will be displayed in the bottom right corner on LED display at any time: In **STANDBY mode** press the **ALARM button** to activate or deactivate the alarm. If the alarm is activated 'A ON' will appear on the **LED display**. If the alarm is deactivated 'A OFF' will be displayed.

When the alarm sounds, press the **SNOOZE button** on the remote control to stop the alarm temporarily, the alarm will sound again after nine minutes. Press **POWER button** to turn off the alarm.

## Sleep Mode

Your Curve iPad Dock has a sleep mode that will automatically set the device to standby after a set period of time.

- 1 While listening to your device, repeatedly press the **SLEEP button** to cycle between 90, 80, 70, 60, 50, 40, 30, 20, 10 and OFF minutes.
- 2 Once the correct sleep time is selected, press the **SELECT button** to confirm your choice.
- 3 Your device will automatically switch to standby after the selected time has elapsed.

Problem	What to do
<b>iPhone/iPod/iPad</b>	
System does not turn on	Make sure AC/DC power adaptor is secure in the outlet and the outlet has power.
iPod/iPhone/iPad in place but unit won't play	Make sure that your iPhone/iPod/iPad is working properly before docking into the unit. Please refer to your iPhone/iPod/iPad manual for details.
	Make sure the volume is not set to the minimum level.
	Pause mode is activated.
iPhone/iPod/iPad does not dock properly or does not install properly	Remove your iPhone/iPod/iPad from the dock and check for obstructions on the connectors in the dock and on your iPhone/iPod/iPad.
<b>Radio</b>	
Poor FM reception	Make sure FM aerial cable is fully extended and adjusted for optimum reception.
	Electrical interference in your home can cause poor reception, move the unit away from those areas (especially those near motors and transformers).

- 1 Do not use harsh or abrasive cleaning agents or solvents.
- 2 Polish the product with soft cloth.
- 3 Do not attempt to disassemble your product.
- 4 Do not paint your product.
- 5 Do not drop, throw or try to bend your product.
- 6 Do not expose your product to open flames or lit tobacco products.

## Warnings

07

This product was designed and manufactured to meet strict quality and safety standards. There are, however, some operation precautions that you should be aware of:

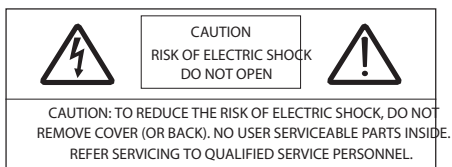

- Read all warnings. Follow all instructions.
- Check the mains voltage stated on the mains adaptor rating plate corresponds to the local electricity supply, if it doesn't, return the product to the store where you bought it.
- Unwind and straighten the power cord before use.
- Place the product on a firm, flat surface. Allow space around the product to ensure enough ventilation.
- To completely disconnect this product from the mains, disconnect the plug from the wall socket outlet. The mains plug is used to completely interrupt the power supply to the unit and must be easily operable by the user.
- Remove the plug from the outlet, when the product is unused for a long period of time and during thunderstorms.
- Clean only with a dry cloth, unplug the outlet before cleaning. Do not use aggressive cleaners as these will damage the surface.
- Only use attachments/accessories specified by the manufacturers.
- Do not locate the appliance in the vicinity of a heat source or in direct sunlight. Do not place a naked flame source on or near this product.
- Do not attempt to open the cabinet or remove any covers. If the power adaptor or its lead becomes damaged, it must be replaced with an adaptor of the same type and rating.
- Repairs must only be performed by the manufacturer or its service agent or similarly qualified person.
- Do not immerse the main unit, the power adapter or any accessories in water or any other liquid.
- Do not expose this product to dripping or splashing or stand any vessel containing liquid on or near this product.
- Replace batteries with the same or equivalent type.
- Do not cover the product or this will impede ventilation.

Power supply	100-240V~ 50/60Hz - 0.8A MAX
Power output	9V $\equiv$ 2A
FM/DAB Frequency	FM 87.5~108MHz
Standby power consumption	0.9W
Power consumption	17W
Speaker output	5W*2

**WWW.CALIBER.NL**

**CALIBER HEAD OFFICE** • The Netherlands • Fax: +31 (0)416 69 90 01 • E-mail: [info@caliber.nl](mailto:info@caliber.nl)